



5SDF 0103Z0401

High Frequency Housingless Welding Diode

Properties

- High forward current capability
- Low forward and reverse recovery losses

Applications

- Welding equipment
- High current application up to 10 kHz

Key Parameters

V_{RRM}	=	400	V
I_{FAVm}	=	10 266	A
I_{FSM}	=	54 000	A
V_{TO}	=	0.998	V
r_T	=	0.027	mΩ

Types

	V_{RRM}
5SDF 0103Z0401	400 V
Conditions:	$T_j = -40 \div 190 \text{ }^\circ\text{C}$, half sine waveform, $f = 50 \text{ Hz}$

Mechanical Data

F_m	Mounting force	30 ÷ 50 kN
m	Weight	0.11 kg
D_s	Surface creepage distance	2 mm
D_a	Air strike distance	2 mm

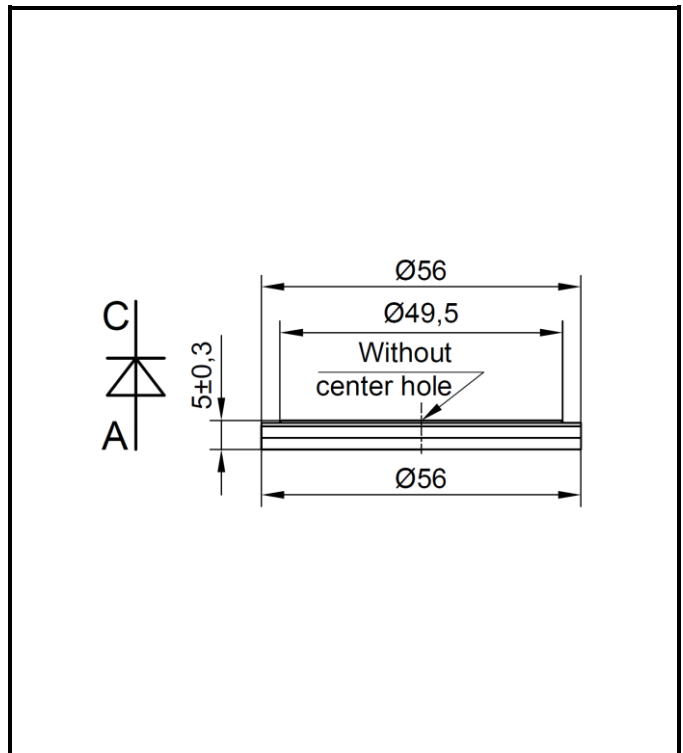

Fig. 1 Case



ABB s.r.o.

Novodvorska 1768/138a, 142 21 Praha 4, Czech Republic

tel.: +420 261 306 250, <http://www.abb.com/semiconductors>

Maximum Ratings			Maximum Limits	Unit
V_{RRM}	Repetitive peak reverse voltage $T_j = -40 \div 190 \text{ }^\circ\text{C}$		400	V
I_{FAVM}	Average forward current	$T_c = 85 \text{ }^\circ\text{C}$	10 266	A
		$T_c = 110 \text{ }^\circ\text{C}$	8 431	
I_{FRMS}	RMS forward current	$T_c = 85 \text{ }^\circ\text{C}$	16 125	A
		$T_c = 110 \text{ }^\circ\text{C}$	13 243	
I_{RRM}	Repetitive reverse current $V_R = V_{RRM}$		200	mA
I_{FSM}	Non repetitive peak surge current $V_R = 0 \text{ V, half sine pulse}$	$t_p = 8.3 \text{ ms}$	57 700	A
		$t_p = 10 \text{ ms}$	54 000	
Pt	Limiting load integral $V_R = 0 \text{ V, half sine pulse}$	$t_p = 8.3 \text{ ms}$	13 809 000	A²s
		$t_p = 10 \text{ ms}$	14 580 000	
$T_{jmin} - T_{jmax}$	Operating temperature range		- 40 \div 190	°C
$T_{stgmin} - T_{stgmax}$	Storage temperature range		- 40 \div 190	

Unless otherwise specified $T_j = 190 \text{ }^\circ\text{C}$

Characteristics			Value			Unit
			<i>min</i>	<i>typ</i>	<i>max</i>	
V_{T0}	Threshold voltage				0.998	V
r_T	Forward slope resistance $I_{F1} = 10\,000 \text{ A, } I_{F2} = 30\,000 \text{ A}$				0.027	mΩ
V_{FM}	Maximum forward voltage	$I_{FM} = 8\,000 \text{ A}$			1.200	V
		$I_{FM} = 10\,000 \text{ A}$			1.270	
Q_{rr}	Recovered charge $I_{FM} = 2\,000 \text{ A, } di/dt = -30 \text{ A}/\mu\text{s, } V_R = 50 \text{ V}$				230	μC

Unless otherwise specified $T_j = 190 \text{ }^\circ\text{C}$

Thermal Parameters			Value	Unit
R_{thjc}	Thermal resistance junction to case	<i>double side cooling</i>	5.0	K/kW
		<i>anode side cooling</i>	6.6	
		<i>cathode side cooling</i>	20.3	
R_{thch}	Thermal resistance case to heatsink	<i>double side cooling</i>	2.5	K/kW
		<i>anode side cooling</i>	4.5	
		<i>cathode side cooling</i>	5.7	

Transient Thermal Impedance

Analytical function for transient thermal impedance

$$Z_{thjc} = \sum_{i=1}^4 R_i (1 - \exp(-t / \tau_i))$$

Conditions:
 $F_m = 30 \div 50$ kN, Double side cooled

Correction for periodic waveforms

180° sine:	1.1 K/kW
180° rectangular:	1.0 K/kW
120° rectangular:	1.5 K/kW
60° rectangular:	2.4 K/kW

<i>i</i>	1	2	3	4
τ_i (s)	0.0480	0.0230	0.0071	0.0009
R_i (K/kW)	4.0934	0.1986	0.5798	0.1353

Fig. 2 Dependence transient thermal impedance junction to case on square pulse

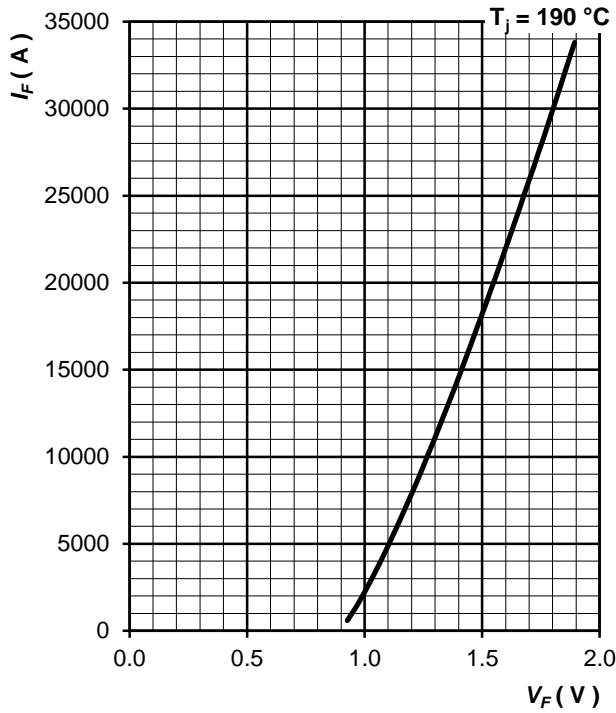

Fig. 3 Maximum forward voltage drop characteristics

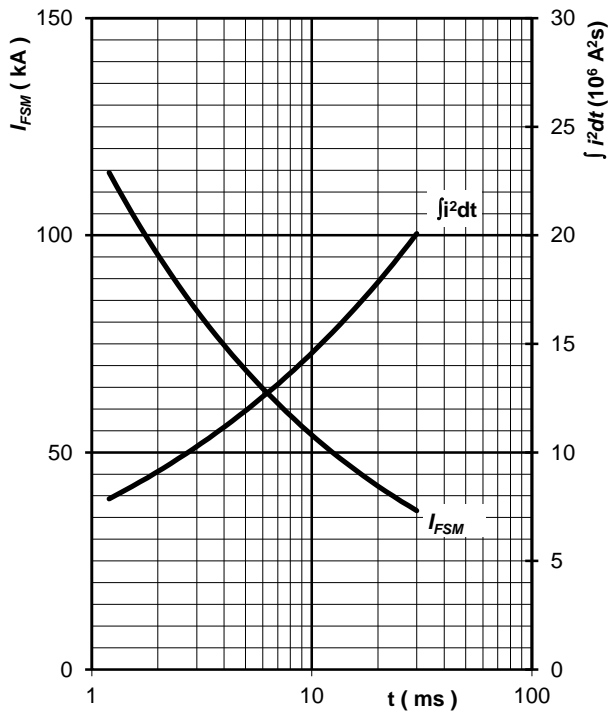

Fig. 4 Surge forward current vs. pulse length, half sine wave, single pulse, $V_R = 0 \text{ V}$, $T_j = T_{jmax}$

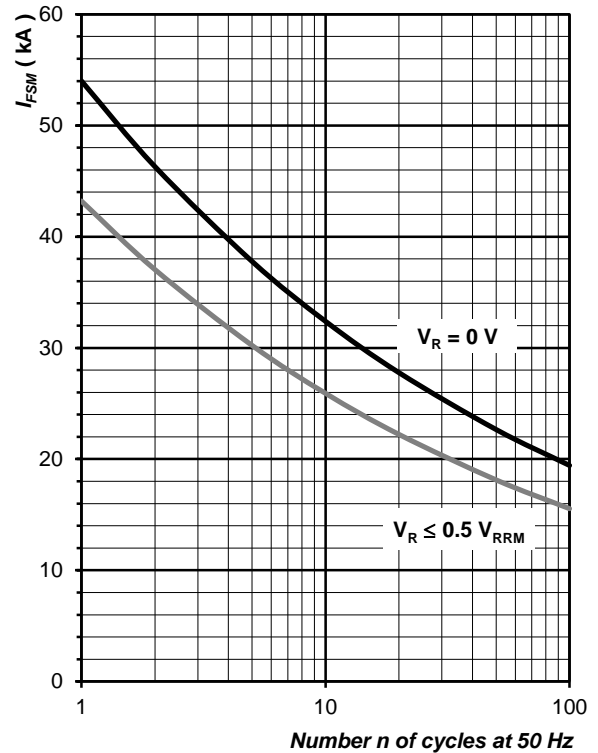

Fig. 5 Surge forward current vs. number of pulses, half sine wave, $T_j = T_{jmax}$

ABB s.r.o., Novodvorska 1768/138a, 142 21 Praha 4, Czech Republic

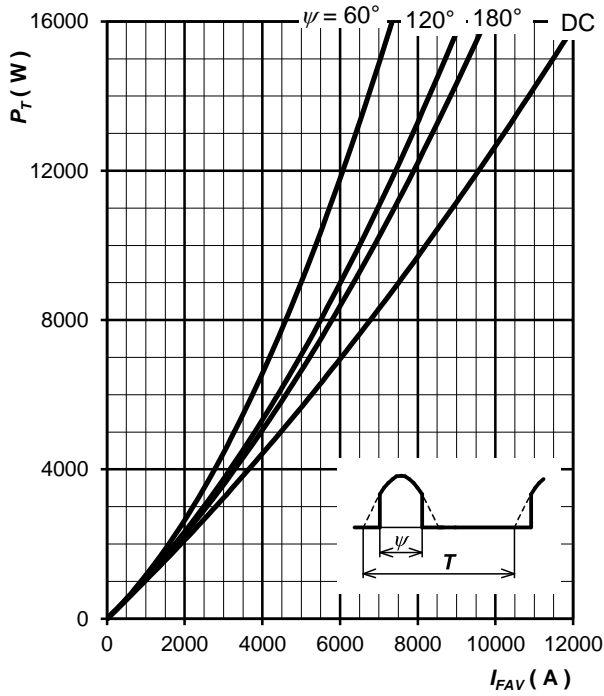

Fig. 6 Forward power loss vs. average forward current, sine waveform, $f = 50 \text{ Hz}$, $T = 1/f$

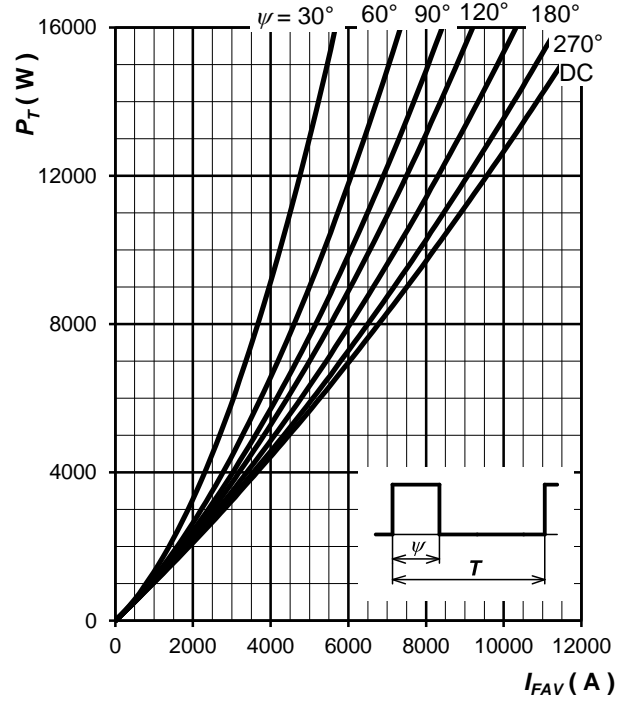

Fig. 7 Forward power loss vs. average forward current, square waveform, $f = 50 \text{ Hz}$, $T = 1/f$

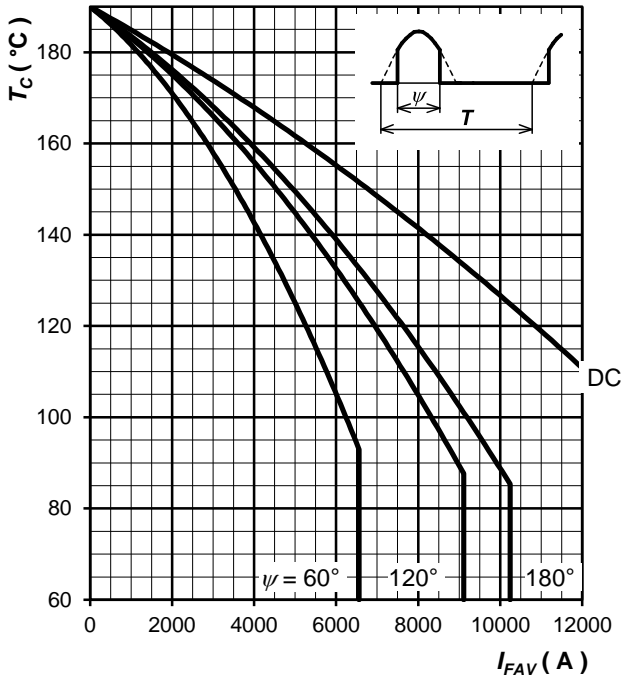

Fig. 8 Max. case temperature vs. aver. forward current, sine waveform, $f = 50 \text{ Hz}$, $T = 1/f$

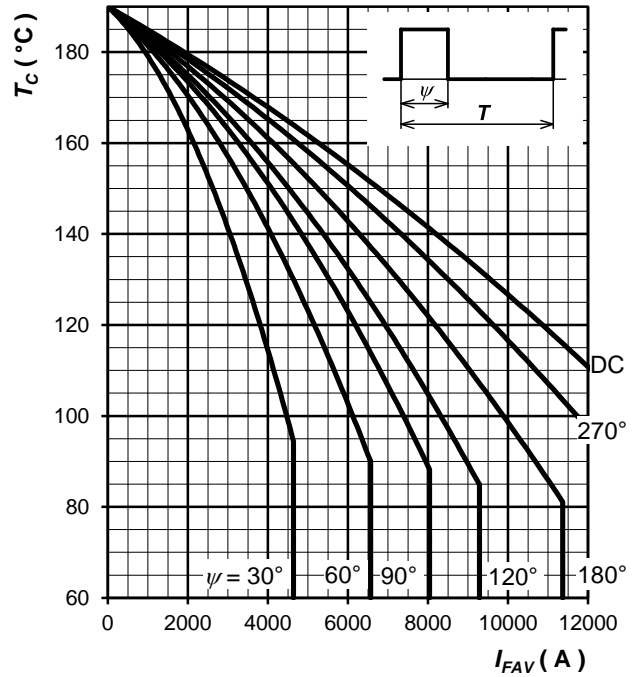

Fig. 9 Max. case temperature vs. aver. forward current, square waveform, $f = 50 \text{ Hz}$, $T = 1/f$

Note 2: Figures number 6 ÷ 9 have been calculated without considering any forward and reverse recovery losses. They are valid for $f = 50$ or 60 Hz operation.

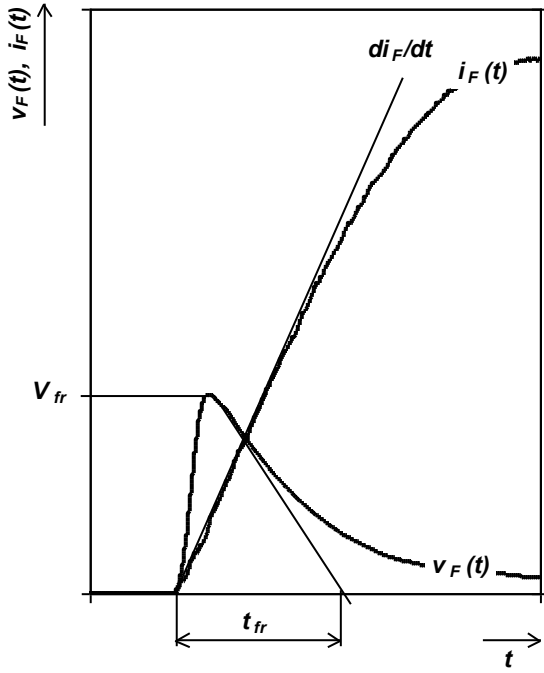

Fig. 10 Typical forward recovery voltage waveform when the diode is turned on with high di_F/dt

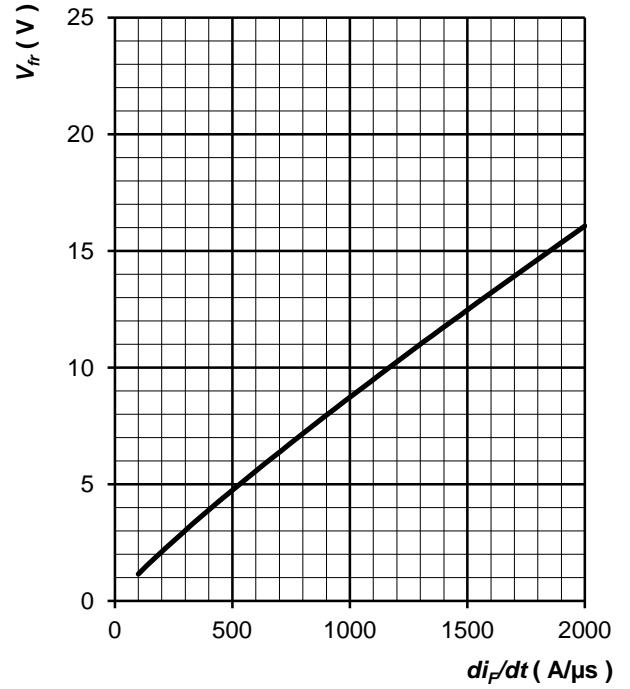

Fig. 11 Max. forward recovery voltage vs. rate of rise forward current, trapezoid pulse, $T_j = T_{jmax}$, $t_{fr} \leq 10 \mu s$

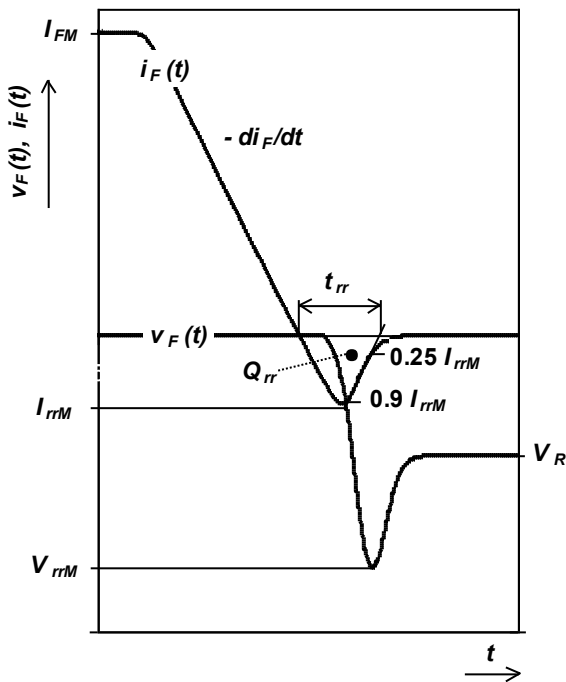

Fig. 12 Definition of reverse recovery parameters

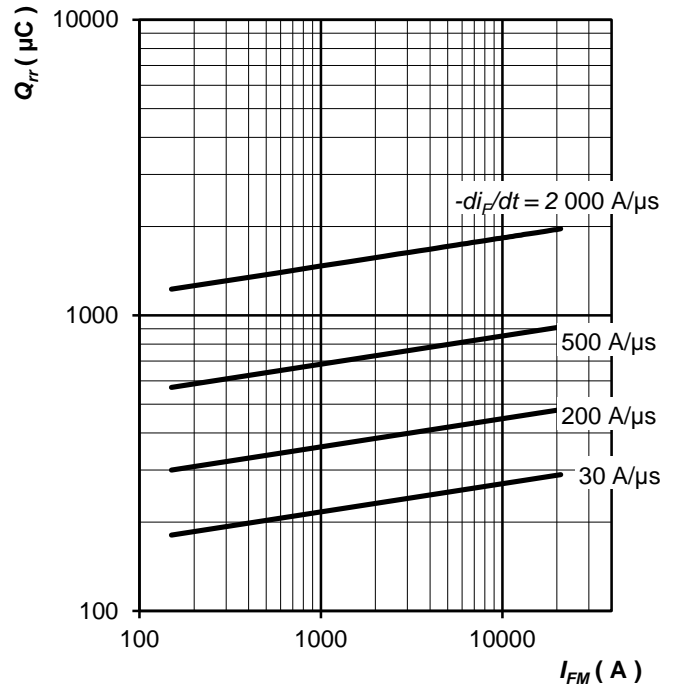

Fig. 13 Max. recovered charge vs. forward current, trapezoid pulse, $T_j = T_{jmax}$

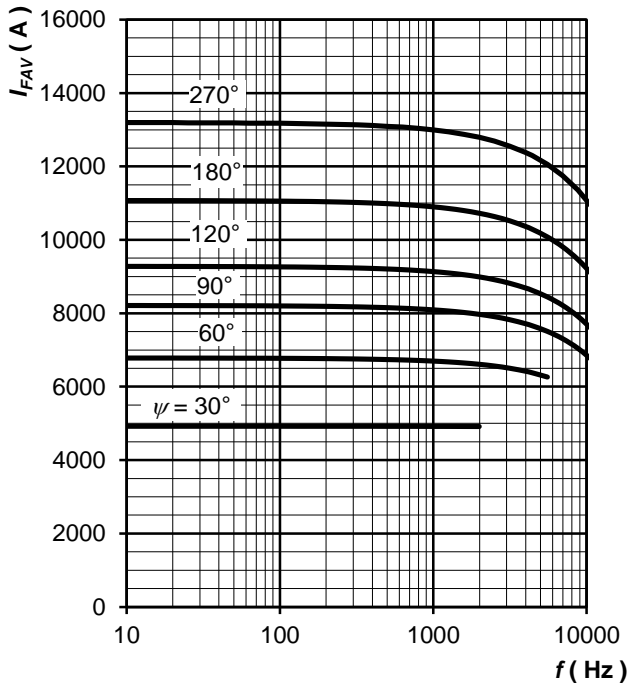

Fig. 14 Average forward current vs. frequency, trapezoid waveform, $T_C = 85^\circ\text{C}$, $di_F/dt = \pm 2\,000\text{ A}/\mu\text{s}$, $V_R = 50\text{ V}$

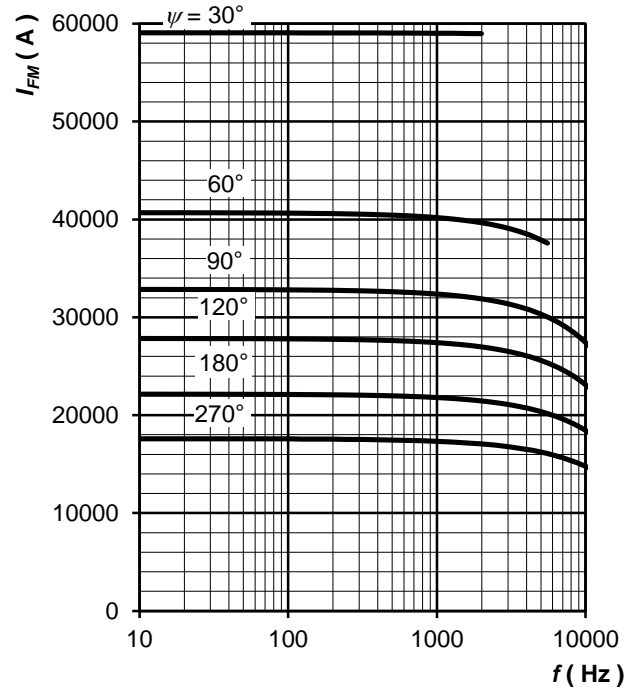

Fig. 15 Maximum forward current vs. frequency, trapezoid waveform, $T_C = 85^\circ\text{C}$, $di_F/dt = \pm 2\,000\text{ A}/\mu\text{s}$, $V_R = 50\text{ V}$

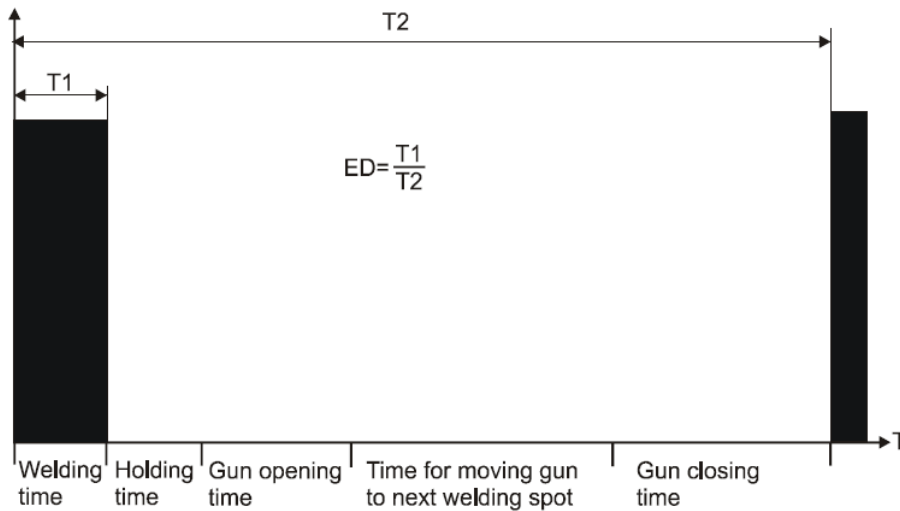

Fig. 16 Definition of ED for typical welding sequence

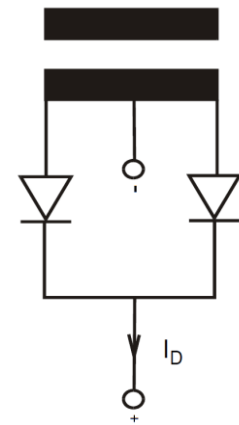

Fig. 17 Definition of I_D for single-phase centre tap

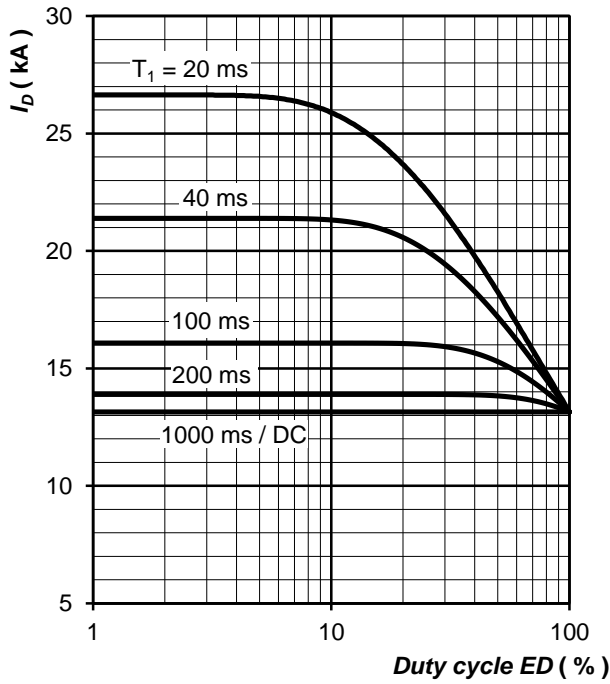

Fig. 18 Current load capacity, cont.,
DC output welding current with single-phase
centre tap vs. duty cycle
 $f = 10 \text{ kHz}$, square wave, $\Delta T_j = 80 \text{ }^\circ\text{C}$

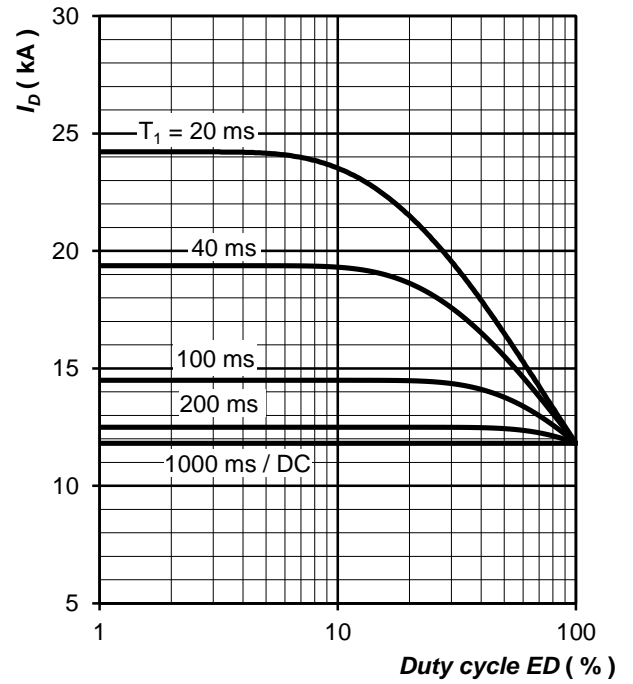

Fig. 19 Current load capacity, cont.,
DC output welding current with single-phase
centre tap vs. duty cycle
 $f = 10 \text{ kHz}$, square wave, $\Delta T_j = 70 \text{ }^\circ\text{C}$

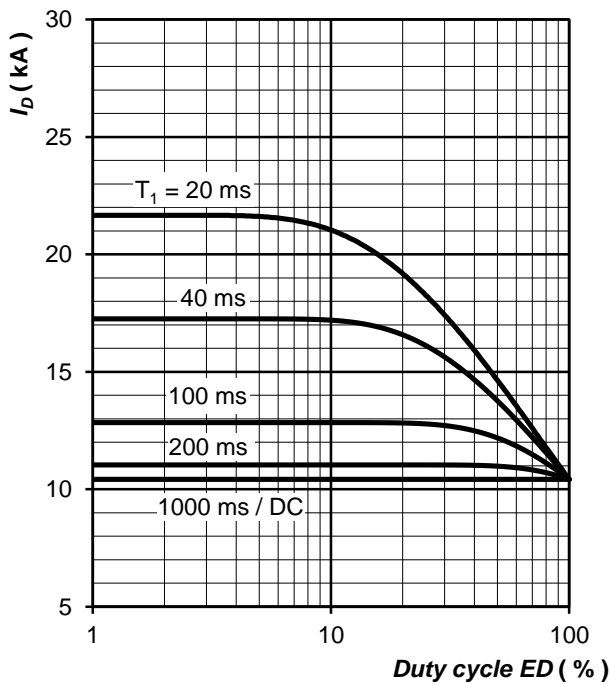

Fig. 20 Current load capacity, cont.,
DC output welding current with single-phase
centre tap vs. duty cycle
 $f = 10 \text{ kHz}$, square wave, $\Delta T_j = 60 \text{ }^\circ\text{C}$

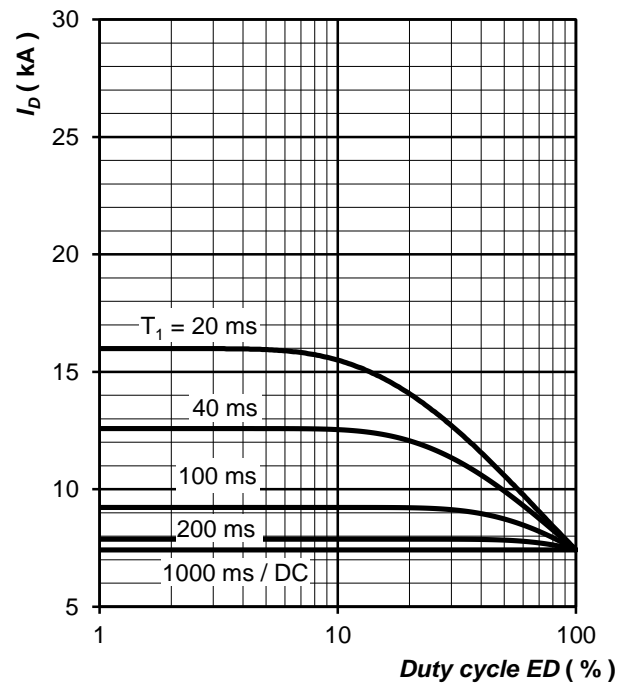

Fig. 21 Current load capacity, cont.,
DC output welding current with single-phase
centre tap vs. duty cycle
 $f = 10 \text{ kHz}$, square wave, $\Delta T_j = 40 \text{ }^\circ\text{C}$

ABB s.r.o., Novodvorska 1768/138a, 142 21 Praha 4, Czech Republic

Notes:

ABB s.r.o., Novodvorska 1768/138a, 142 21 Praha 4, Czech Republic